

**Multiblindo**  **Motion**  
Electromechanical  
automatic lock





## Multiblindo Motion

Perfect combination of comfort and security in any situation.

The new electromechanical automatic lock represents the electronic evolution of Multiblindo Easy.

From the outside it operates by key or the most advanced electronic access control systems: fingerscan, keyboard, transponder, PIN-code. From the inside it operates electronically in a simple and fast way through a normal keyboard, allowing the end user to set three different locking functions: Total, Light, Free.



### It is certified

according to EN14846:08 and prEN15685:09 European standards.

Multiblindo eMotion ensures top-level intrusion protection; it doesn't lose the settings in case of a blackout and, if necessary, it always assures the mechanical key or handle action.

Example of certification:



### With sound feedback

A special system monitors the door status and sends opening and closing sound signals, which can be set or completely excluded by the end user.



### Set your time

The user can set the time span between the opening pulse and the automatic relocking of the door.

Multiblindo eMotion has three options allowing an instant opening as well as to choose the automatic relocking mode according to the user's security requirements. It is operated through an electronic control for all the settings.

**Total.** When pressing the pushbutton the door opens and a sound signal is produced. When it closes, Multiblindo eMotion will automatically trigger the latchbolt and deadbolts: the sound feedback will indicate the total locking. Total security: this setting ensures your door the highest security.

**Light.** When pressing the pushbutton the door opens and a sound signal is produced. When it closes, Multiblindo eMotion will automatically trigger the latchbolt only: a different and more flexible security level for a partial and fast locking.

**Free.** With this setting, Multiblindo eMotion keeps the latchbolt and deadbolts completely unlocked: the door will stay in a free-opening status, in the classic hold-open situation. Total freedom ensuring a free access both from inside and outside until a new setting is given.

## Conventional definition of door handing.

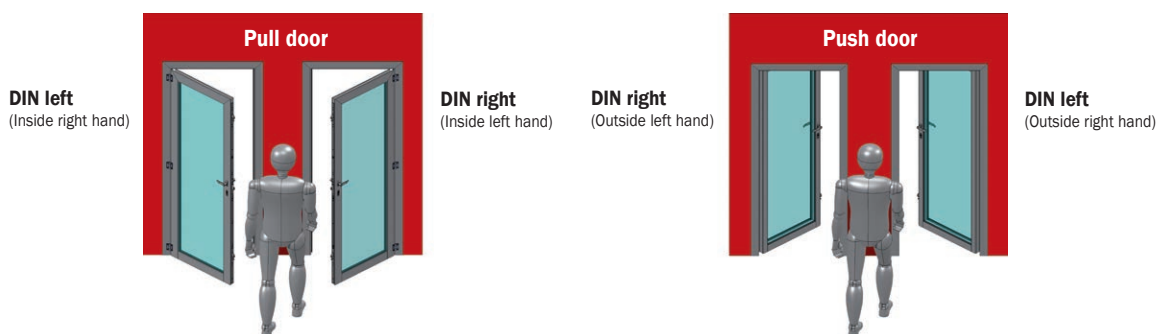

**Multiblando**  **Motion**

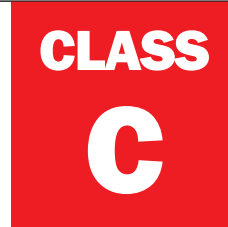

**Vds** **Zertifikat**  
über die  
**Anerkennung**  
von  
**Bauteilen und Systemen**

*Wieder der Anerkennung:*  
Iseo Serrature s.p.a.  
Via S. Girolamo 13  
IT-25055 Pisogne (BS)

Anerkennung-Nr.	Anzahl der Bauteile	Gültig vom	Gültig bis
M 110357	4	10.12.2010	09.12.2014

Gegenstand der Anerkennung:  
**Zylinderschloss - Klasse C**  
**Baureihe Multiblando**

Vereinbarung:  
**als mechanische Sicherungseinrichtung**

*Anerkennungsgrundlagen:*  
VDS 2344 : 2005-12, Verfahren für die Prüfung, Anerkennung und Konformitätsbewertung von Geräten, Bauteilen und Systemen der Brandschutz- und Sicherungstechnik  
VDS 2841 : 2005-12, Durchführung von Produktüberwachungen  
VDS 2201 : 2004-02, Richtlinien für mechanische Sicherungseinrichtungen, Zylinderschlösser, Anforderungen und Prüfmethoden  
DIN 18 251-3 : 2002-11, Schlösser, Einsteckschlösser als Mehrfachverriegelung

Köln, den 10. Dezember 2010

  
Schlingel  
Geschäftsführer

  
ppa. Urban  
Leiter der Zertifizierungsstelle

  
DAT-ZE 005/02

*VDS Sachverständigenbüro GmbH*  
Zertifizierungsstelle  
Anwaltsstraße 11a  
D-50755 Köln  
Ein Unternehmen des Gesamtverbandes der Deutschen Versicherungswirtschaft e.V. (GDV) angeschlossen an die Zertifizierungsstelle für die Bereiche Brandschutz- und Sicherungstechnik vom Deutschen Anwaltsvereinsgesetz Technische Fachstelle (DAFach)

**VDS** is an independent German institute.  
A VDS certification helps end users to distinguish high quality from mediocre products and services.  
ISEO Serrature has obtained the highest security certification for Multiblando product range, **CLASS C**.



## Multiblindo Motion EXIT

The new electromechanical automatic lock Multiblindo eMotion EXIT with panic function has got the same features as the lock Multiblindo eMotion. The system is made up of the lock and the operating bar. A microswitch detects and signals the deadbolt status. From the outside it operates by key or the most advanced electronic access systems: fingerscan, keyboard, transponder, PIN-code. From the inside it operates electronically in a simple and fast way through a normal keyboard. The end user can choose the locking mode according to his security requirements: Total, Light, Free. The deadbolts and latchbolt are always operated by the panic bar.



### It is certified

according to the EN 1125:08 standard in combination with its striking plates and operating bar Pro EXIT, with the following certification:



### Pro EXIT operating bar

Operating bar on which a microswitch can be applied. It detects the emergency opening.



### Set your time

The user can set the time span between the opening pulse and the automatic relocking of the door.

Multiblindo eMotion has three options allowing an instant opening as well as to choose the automatic relocking mode according to user's security requirements. It is operated through an electronic control for all the settings.

**Total.** When pressing the pushbutton the door opens and a sound signal is produced. When it closes, Multiblindo eMotion will automatically trigger the latchbolt and deadbolts: the sound feedback will indicate the total locking. Total security: this setting ensures your door the highest security.

**Light.** When pressing the pushbutton the door opens and a sound signal is produced. When it closes, Multiblindo eMotion will automatically trigger the latchbolt only: a different and more flexible security level for a partial and fast locking.

**Free.** With this setting, Multiblindo eMotion keeps the latchbolt and deadbolts completely unlocked: the door will stay in a free-opening status, in the classic hold-open situation. Total freedom ensuring a free access both from inside and outside until a new setting is given.





Code  
Status  
Single package  
Multiple package  
Min. ord.

**Multiblindo eMotion EXIT 92 mm centre distance**

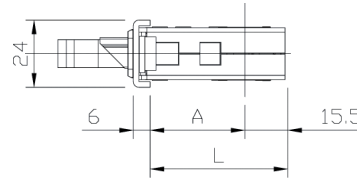
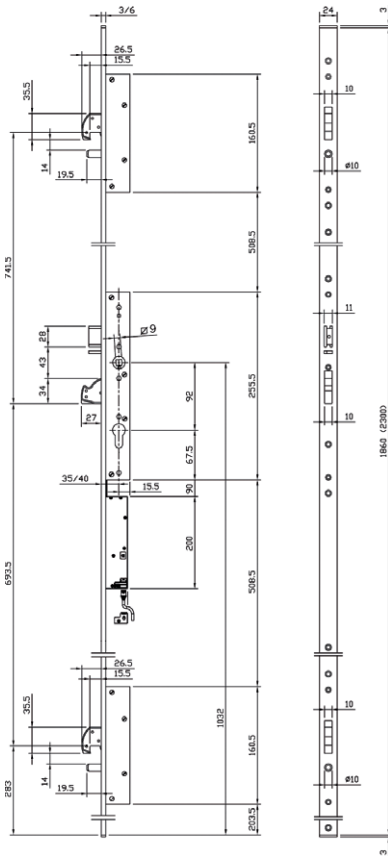

ENTRATA	A	L
35	28	43.5
40	33	48.5

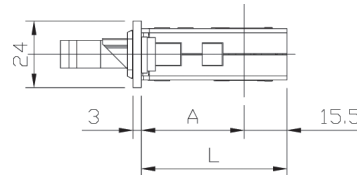

ENTRATA	A	L
35	32	47.5
40	37	52.5

Multiblindo eMotion EXIT with panic function is operated by an horizontal bar and is made up of the **ELECTROMECHANICAL 12V D.C. MULTIPPOINT** mortice lock for metal frames in combination with its striking plates, and operating bar Pro EXIT.

**AUTOMATIC LOCKING OF THE LATCHBOLT AND 3 DEADBOLTS. ROTATING HOOK DEVIATORS.**

With microswitch detects and signals the deadbolt status. Central lock, centre distance mm 92, operating with European profile cylinder. Right or left latchbolt, **non reversible**. Deadbolts and latchbolt operated by key, handle or motor. Lock and deviators deadbolts mm 27 throw, with anti-drill and anti-cut cover plates in carbonitrided steel. Connection cable, 2 nylon end blocks for U-version. Fixing screws. Instruction sheet.

**Accessories to be ordered separately:** Striking plates 03320\* - Deviators striking plates 033165 - 033167 - 033169 - 033171

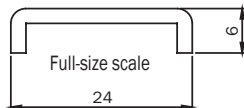

U-front plate <b>2300x24x6</b> in stainless steel. Backset mm 35 <b>DIN RIGHT</b>	<b>7A37003521D.A</b>	B	1	-	1
U-front plate <b>2300x24x6</b> in stainless steel. Backset mm 35 <b>DIN LEFT</b>	<b>7A37003521S.A</b>	B	1	-	1
U-front plate <b>2300x24x6</b> in stainless steel. Backset mm 40 <b>DIN RIGHT</b>	<b>7A37004021D.A</b>	C	1	-	1
U-front plate <b>2300x24x6</b> in stainless steel. Backset mm 40 <b>DIN LEFT</b>	<b>7A37004021S.A</b>	C	1	-	1

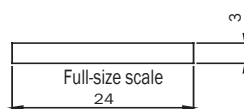

Flat front-plate <b>2300x24x3</b> in stainless steel. Backset mm 35 <b>DIN RIGHT</b>	<b>7A37103521D.A</b>	C	1	-	1
Flat front-plate <b>2300x24x3</b> in stainless steel. Backset mm 35 <b>DIN LEFT</b>	<b>7A37103521S.A</b>	C	1	-	1
Flat front-plate <b>2300x24x3</b> in stainless steel. Backset mm 40 <b>DIN RIGHT</b>	<b>7A37104021D.A</b>	D	1	-	1
Flat front-plate <b>2300x24x3</b> in stainless steel. Backset mm 40 <b>DIN LEFT</b>	<b>7A37104021S.A</b>	D	1	-	1



Code

Status  
Single  
package

Min. ord.

**Option: with hole for SWISS profile cylinder**



For cylinder 22 mm

**Multiblindo Motion**

**ELECTROMECHANICAL central lock, centre distance 94 mm**  $\nabla 9$ .

U-front plate mm <b>2300x24x6</b> in stainless steel. Backset 40 mm <b>DIN RIGHT</b>	<b>7A3800402.D</b>	D	1	-	1
U-front plate mm <b>2300x24x6</b> in stainless steel. Backset 40 mm <b>DIN LEFT</b>	<b>7A3800402.S</b>	D	1	-	1

Flat front-plate mm <b>2300x24x3</b> in stainless stEel. Backset 40 mm <b>DIN RIGHT</b>	<b>7A3810402.D</b>	D	1	-	1
Flat front-plate mm <b>2300x24x3</b> in stainless steel. Backset 40 mm <b>DIN LEFT</b>	<b>7A3810402.S</b>	D	1	-	1

**Multiblindo Motion EXIT**

**ELECTROMECHANICAL central lock, centre distance 94 mm**  $\nabla 9$ .

U-front plate mm <b>2300x24x6</b> in stainless steel. Backset 40 mm <b>DIN RIGHT</b>	<b>7A38004021D.A</b>	D	1	-	1
U-front plate mm <b>2300x24x6</b> in stainless steel. Backset 40 mm <b>DIN LEFT</b>	<b>7A38004021S.A</b>	D	1	-	1

Flat front-plate mm <b>2300x24x3</b> in stainless steel. Backset 40 mm <b>DIN RIGHT</b>	<b>7A38104021D.A</b>	D	1	-	1
Flat front-plate mm <b>2300x24x3</b> in stainless steel. Backset 40 mm <b>DIN LEFT</b>	<b>7A38104021S.A</b>	D	1	-	1





