



**Locks for
metal frames**





Multiblindo Easy
Automatic lock



Multiblindo Easy

It is a Multiblindo by all means: same sizes and dimensions, same security level. But it is an all-new Multiblindo, **conceived with 3 different functions to be set by the end user.**

To use Multiblindo Easy you need to apply an external fixed knob or a pull handle; as a matter of fact, a “classic handle” would unlock the door (emergency function).



It has been designed and tested

according to the European standard prEN 15685.

It resists lateral forcing with a thrust of over 1,000 kg and a front load of over 600 kg.

The corrosion resistance is more than 240 hours in a saline environment.

Endurance: tested to over 200,000 opening and closing cycles under a 120N load.

Example of certification: lock Multiblindo Easy, models 7A32 – 7A34 – 7A36 – 7A38



Locking.

The outstanding feature of Multiblindo Easy is the automatic locking of the latchbolt and deadbolts, which comes into operation when the door is pulled close to the door jamb. The end user may change the operating mode by switching the selector placed on the lock front plate. A special patented device allows the deadbolts to come out of the cases only when the latchbolt goes into the striking plate for at least 3 mm. The latchbolt aligns perfectly the wing to the door jamb; this operation ensures the best condition for the free movement of the deadbolts.



Opening.

Outside opening: the deadbolts are unlocked with a single turn of the key in the opening direction; the latchbolt is unlocked with a further ¼ turn.

Inside opening: the deadbolts are unlocked with a single turn of the key in the opening direction; the latchbolt is unlocked with a further ¼ turn.

Latchbolt and deadbolts are unlocked with 45° lever rotation.

Lever block.

The lever operation inside is blocked with a single turn of the key in the closing direction.

The operation is restored with single turn of key in the opposite direction. To avoid incorrect or accidental use, the lever block operation is only allowed when the deadbolts are completely locked. This also ensures that:

- deadbolts automatic locking is fully completed
- deadbolts connecting rod has been blocked (an attack on one of the deadbolts does not damage the others). As far as security is concerned, the lever block prevents the opening from inside if required, or from outside in the event of a door breaking (i.e. glass frame doors).

In terms of safety it ensures a better exit control.



Total “0” Deadbolts and latchbolt automatic locking



Light “1” Locking by latchbolt only



Free “2” Setting without locking (it allows to set the hold-open function)



Multiblindo Easy

Nachweis einbruchhemmende Eigenschaften
Prüfbericht 212 38908

Auftraggeber Hörmann KG Eckelhausen
in der Bruchweise 2
66625 Nohfelden

Produkt einbruchhemmende Tür mit festem Seitenteil
Bezeichnung TopPrestige

Außenmaß (B x H) 2300 mm x 2300 mm
Rahmen/Material-System Aluminium / Hörmann H20000, H21000, H25000
Angriffsstelle Schließseite/Schließfläche nach DIN 107
Öffnungsart Drehflügel nach innen
Klasse P4 A Nach EN 356
Verglasung Alupanel ohne Nachweis
Automatikschloss, Dreifachverriegelung mit Bolzen-, Hakenkombination, Typ Iso-Multiblindo Hörmann-H5, Fa. Iso Serrature; Profizylinder Typ P4 Iso; Schutzbeschlag Hörmann-HS1; zwei zweiteilige Bänder Nr. 4, Fa. Dr. Walter Hahn
Beschläge Gemäß der Montageanleitung der Firma Hörmann KG Eckelhausen
Montage
Schließzustand geschlossen, verriegelt und verschlossen

Einbruchhemmung
 Widerstandsklasse 2

IFT Rosenheim
17. Dezember 2009

Christian Walter
Christian Walter, Dipl.-Ing. (FH)
Prüfstellenleiter
IFT Zentrum Türen, Tore, Sicherheit

Gerhard Fellermeier, Dipl.-Ing. (FH)
Gerhard Fellermeier, Dipl.-Ing. (FH)
Prüfingenieur
IFT Zentrum Türen, Tore, Sicherheit

IFT Rosenheim Gruppe
IFT Zentrum - Türen, Tore, Sicherheit
Deutschhofstr. 1
89076 Rosenheim

Technik- und Zert. Zert. 1
D-85059 Rosenheim
Tel. +49 (0)89 207 00 0
Fax +49 (0)89 207 00 300
www.ift-rosenheim.de

ISO 9001:2008 zertifiziert
A2 - Rosenheim IFT 16022
DIN EN ISO 14001
DIN EN ISO 14001
DIN EN ISO 14001
DIN EN ISO 14001

Noblex Gmbh, 0711
Zertifizierungsgesellschaft
Ankerstr. 177
D-05128 Jena

ifft
ROSENHEIM

Grundlagen
DIN V ENV 1627 : 1999
Fenster, Türen, Abtastlöcher -
Einbruchhemmung - Anforderun-
gen und Klassifizierung
DIN V ENV 1628 : 1999
DIN V ENV 1629 : 1999
DIN V ENV 1630 : 1999

Darstellung

Vermittlungsinhalte
Dieser Prüfbericht dient zum Nachweis der einbruchhemmenden Eigenschaften.

Gültigkeit
Die genannten Daten und Ergebnisse beziehen sich ausschließlich auf den geprüften und beschriebenen Prüfobjekt. Die Prüfung der Einbruchhemmung ermöglicht keine Aussage über weitere Leistungs- und qualitätsbestimmende Eigenschaften der vorliegenden Konstruktion.
Abweichend von geprüften Ausführungen sind folgende Größenänderungen zulässig:
- in der Breite +10% und -20%
- in der Höhe +10% und -20%.

Veröffentlichungshinweise
Es gilt das IFT-Konzept "Zertifizierungen sind Hinweise zur Bestätigung von IFT-Produktqualifikationen".
Das Dokuments kann als Kurzfassung verwendet werden.

Inhalt
Der Nachweis umfasst insgesamt 43 Seiten:
1. Gegenstand
2. Durchführung
3. Einzelergebnisse
4. Beurteilung
Anlage 1 (15 Seiten)
Anlage 2 (11 Seiten)

The door fitted with a Multiblindo Easy lock and tested by the German Institute IFT ROSENHEIM passed **CLASS 2 test according to EUROPEAN STANDARD DIN V ENV 1627**

EUROPEAN STANDARD DIN V ENV 1627.
All MULTIBLINDO series locks have obtained **GRADE 7** according to the security requirement **pr EN 15685.**

Vds

Zertifikat
über die
Anerkennung
VON
Bauteilen und Systemen

Titel der Anerkennung:
Iso Serrature s.p.a.
Via S. Girolamo 13
IT-25055 Pisogone (BS)

Anerkennung-Nr.	Anzahl der Seiten	Gültig vom	Gültig bis
M 110357	4	10.12.2010	09.12.2014

Gegenstand der Anerkennung:
**Zylinderschloss - Klasse C
Baureihe Multiblindo**

Benennung:
als mechanische Sicherungseinrichtung

Zusammenfassung der Anforderungen:
Vds 2344 : 2005-12, Verfahren für die Prüfung, Anerkennung und Konformitätsbewertung von Geräten, Bauteilen und Systemen der Brandschutz- und Sicherungstechnik
Vds 2841 : 2005-12, Durchführung von Produktüberwachungen
Vds 2201 : 2004-02, Richtlinien für mechanische Sicherungseinrichtungen, Zylinderschlösser, Anforderungen und Prüfmethoden
DIN 18 251-3 : 2002-11, Schlösser, Einsteckschlösser als Mehrfachverriegelung

Köln, den 10. Dezember 2010

Schlingel
Schlingel
Geschäftsführer

ppa. Urban
Urban
Leiter der Zertifizierungsbüro

Vds Schadenverhütung GmbH
Zertifizierungsgesellschaft
Ankerstr. 177
D-05128 Jena

Ein Unternehmen des Gesamtverbandes der Deutschen Versicherungswirtschaft e.V. (GDV)
abgetrennt als Zertifizierungsgesellschaft für die Bereiche Brandschutz- und Sicherungstechnik von der Geschäftsbereichs- und Zertifizierungstechnik (GATeC)

Deutscher Institut für Vds
DAT-ZE 005/92



VDS is an independent German institute. A VDS certification helps end users to distinguish high quality from mediocre products and services. ISEO Serrature has obtained the highest security certification for Multiblindo product range, **CLASS C.**



Multiblindo Easy 92 mm centre distance

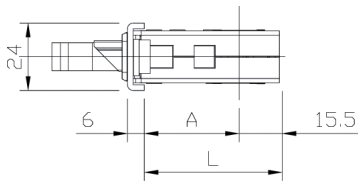
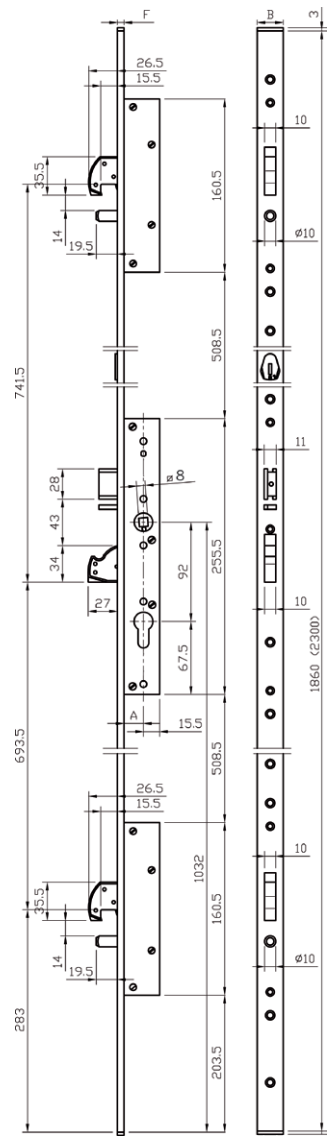
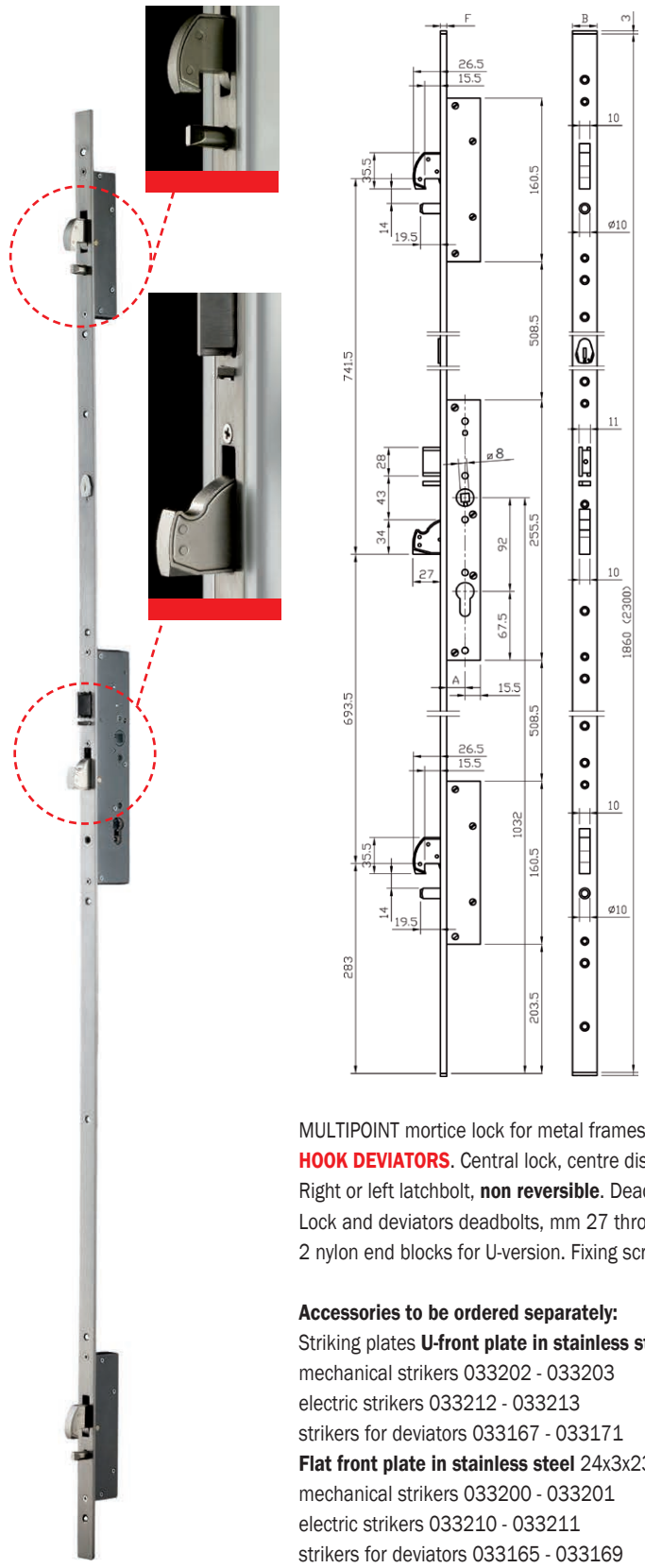

ENTRATA	A	L
35	28	43.5
40	33	48.5

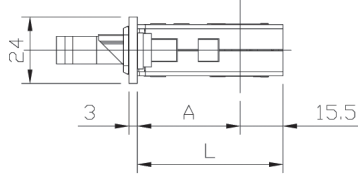

ENTRATA	A	L
35	32	47.5
40	37	52.5

MULTIPOINT mortice lock for metal frames, AUTOMATIC LOCKING OF THE LATCHBOLT AND 3 DEADBOLTS, **ROTATING HOOK DEVIATORS**. Central lock, centre distance mm 92, operating with European profile cylinder. Right or left latchbolt, **non reversible**. Deadbolts and latchbolt operated by key or handle. Lock and deviators deadbolts, mm 27 throw, with anti-drill and anti-cut cover plates in carbonitrided steel. 2 nylon end blocks for U-version. Fixing screws. Instruction sheet.

Accessories to be ordered separately:
 Striking plates **U-front plate in stainless steel** 24x6x1860:
 mechanical strikers 033202 - 033203
 electric strikers 033212 - 033213
 strikers for deviators 033167 - 033171
Flat front plate in stainless steel 24x3x2300:
 mechanical strikers 033200 - 033201
 electric strikers 033210 - 033211
 strikers for deviators 033165 - 033169



Code

Status

Single
package

Multiple
package

Min. ord.

Multiblindo Easy 92 mm centre distance

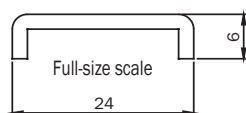

U-front plate mm 1860x24x6 in stainless steel. Backset mm 35 DIN RIGHT	7A3201352.D	B	1	-	1
U-front plate mm 1860x24x6 in stainless steel. Backset mm 40 DIN RIGHT	7A3201402.D	C	1	-	1
U-front plate mm 1860x24x6 in stainless steel. Backset mm 35 DIN LEFT	7A3201352.S	B	1	-	1
U-front plate mm 1860x24x6 in stainless steel. Backset mm 40 DIN LEFT	7A3201402.S	D	1	-	1

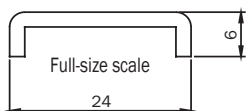

U-front plate mm 2300x24x6 in stainless steel. Backset mm 35 DIN RIGHT	7A3200352.D	B	1	-	1
U-front plate mm 2300x24x6 in stainless steel. Backset mm 40 DIN RIGHT	7A3200402.D	C	1	-	1
U-front plate mm 2300x24x6 in stainless steel. Backset mm 35 DIN LEFT	7A3200352.S	B	1	-	1
U-front plate mm 2300x24x6 in stainless steel. Backset mm 40 DIN LEFT	7A3200402.S	D	1	-	1

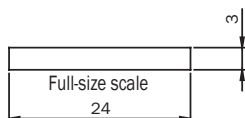

Flat front-plate mm 2300x24x3 in stainless steel. Backset mm 35 DIN RIGHT	7A3210352.D	B	1	-	1
Flat front-plate mm 2300x24x3 in stainless steel. Backset mm 40 DIN RIGHT	7A3210402.D	C	1	-	1
Flat front-plate mm 2300x24x3 in stainless steel. Backset mm 35 DIN LEFT	7A3210352.S	B	1	-	1
Flat front-plate mm 2300x24x3 in stainless steel. Backset mm 40 DIN LEFT	7A3210402.S	C	1	-	1

Conventional definition of door handing.

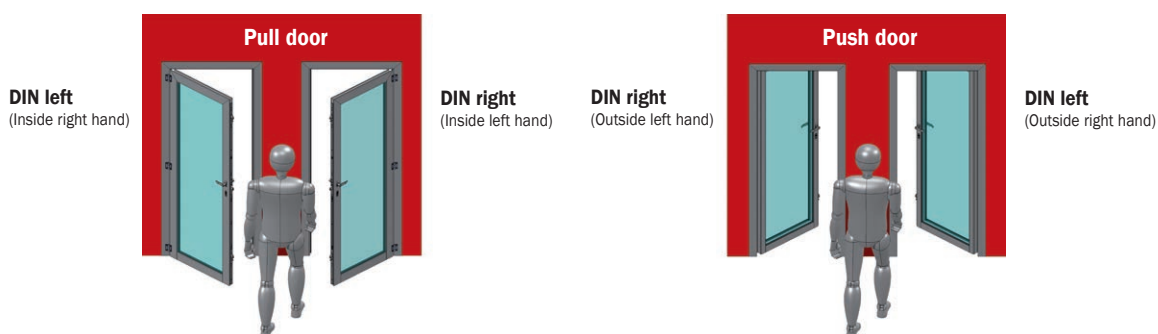



Code

Status

Single
package

Multiple
package

Min. ord.

Option: with hole for SWISS profile cylinder



For cylinder 22 mm



Multiblindo Easy

ELECTROMECHANICAL central lock, centre distance 94 mm ∇ 9.

U-front plate mm 2300x24x6 in stainless steel. Backset 40 mm DIN RIGHT	7A3400402.D	D	1	-	1
U-front plate mm 2300x24x6 in stainless steel. Backset 40 mm DIN LEFT	7A3400402.S	D	1	-	1

Flat front-plate mm 2300x24x3 in stainless steel. Backset 40 mm DIN RIGHT	7A3410402.D	D	1	-	1
Flat front-plate mm 2300x24x3 in stainless steel. Backset 40 mm DIN LEFT	7A3410402.S	D	1	-	1

Multiblindo Easy EXIT

ELECTROMECHANICAL central lock, centre distance 94 mm ∇ 9.

U-front plate mm 2300x24x6 in stainless steel. Backset 40 mm DIN RIGHT	7A34004022D.A	D	1	-	1
U-front plate mm 2300x24x6 in stainless steel. Backset 40 mm DIN LEFT	7A34004022S.A	D	1	-	1

Flat front-plate mm 2300x24x3 in stainless steel. Backset 40 mm DIN RIGHT	7A34104022D.A	D	1	-	1
Flat front-plate mm 2300x24x3 in stainless steel. Backset 40 mm DIN LEFT	7A34104022S.A	D	1	-	1

For locks for metal frames
series 7A*



Code

Min. ord.
Multiple
package
Single
package
Status

Multiblindo Easy and Multiblindo Motion

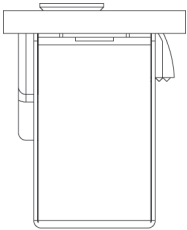

Full-size scale

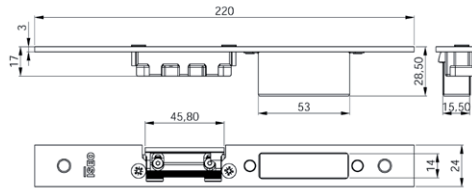

- ALLCO All.Co 5 Porta / All.Co 5 TT Porta
- Export 50/50 TT Porta / Sciriblin 65
- ALLU-K Alublindo / N 45 Porta / N 53 Porta / N 55 TT Porta
- N 62 TT Porta
- ALLU-MEC Synthesis 57 Porta / Synthesis 60TT Porta
- DOMAL Stopper PG Porta
- ESA Blindal 60 Porta 1 Ante / 60 Porta 2 Ante
- INDINVEST Alpha 445 Porta 2 Ante
- METRA NC 45 International Porta
- NC 45 Superthermic Porta / NC 55 International Porta
- NC 68 Superthermic Porta / Nuovo NC 50 Porta
- Superblindo
- PASSERINI Ekip Blindo
- SCHUCO Royal 78 ST Blindato
- Royal S 50 N
- Royal S 55 TT
- Royal S 65 TT

ADJUSTABLE closed striking plate for **CENTRAL LOCK**

MULTIBLINDO EASY and MULTIBLINDO EMOTION. Material: stainless steel.

With mechanical striker.

Flat front-plate **24x3x220 DIN LEFT**

033200 A 10 - 10

Flat front-plate **24x3x220 DIN RIGHT**

033201 A 10 - 10

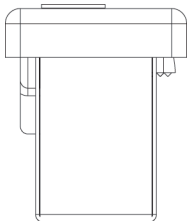

Full-size scale

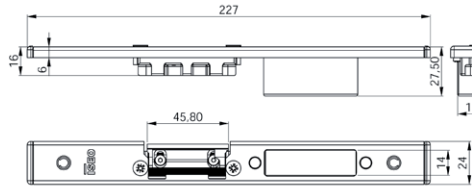

- ALCAN Abithal Keeper Porta 53-60 / 61-68
- Abithal Porta / Winner Porta
- ALCOA FB 12 Blindato Porta
- Plana 1 Ante / Plana 2 Ante
- ALLCO All.Co 5 Porta / All.Co 5 TT Porta
- Export 50/50 TT Porta / Sciriblin 65
- ALNOR Montreal Porta
- ALUSUISSE Aisec 2000 Porta 59 / Aisec 2000 Porta 69
- ALU-K Alublindo / N 45 Porta / N 53 Porta / N 55 TT Porta
- N 62 TT Porta
- ALLU-MEC Synthesis 57 Porta / Synthesis 60TT Porta
- BODEGA Extrablind 70
- DOMAL Domal Break 52 Porta / Domal Break 70 Porta
- Security Porta / Shops Porta / Stopper PG Porta
- ESA Blindal 60 Porta 1 Ante / 60 Porta 2 Ante
- Blindal 70 Porta 1 Ante / 70 Porta 2 Ante
- FRESIA Global 48 Porta
- INDINVEST Alpha 445 Porta 2 Ante
- METRA NC 45 International Porta
- NC 45 Superthermic Porta / NC 55 International Porta
- NC 68 Superthermic Porta / Nuovo NC 50 Porta
- Superblindo
- NEW TEC New Tec 50 Porta Complanare
- OCMA SV 47 Porta 1 Ante
- SV 62 Porta 1 Ante
- SV 62 TT Porta 1 Ante
- PASSERINI Ekip Blindo
- Ekip Maastricht 53 Porta 1 Ante
- Ekip Maastricht 53 Porta 2 Ante
- Ekip Maastricht TH 60/68 Porta 1 Ante
- Ekip Maastricht TH 60/68 Porta 2 Ante
- Ekip Thermo 53 Porta
- PROFILATI PE "Eku 53" Porta
- PE "Eku 64 TT" Porta
- PE "Eku 72 TT" Porta
- Sistema 1 PE 40 Complanare / Esterno 2 Ante
- Sistema 1 PE 40 Sormonto 2 Ante
- SCHUCO Royal 78 ST Blindato
- Royal S 50 N
- Royal S 55 TT
- Royal S 65 TT
- WICONA L60-A / L70-A

ADJUSTABLE closed striking plate for **CENTRAL LOCK**

MULTIBLINDO EASY and MULTIBLINDO EMOTION. Material: stainless steel.

With mechanical striker.

U-front plate **24x6x220 DIN LEFT**

033202 B 10 - 10

U-front plate **24x6x220 DIN RIGHT**

033203 B 10 - 10

For locks for metal frames series 7A*



Code

Min. ord.
Multiple package
Single package
Status

Multiblindo Easy

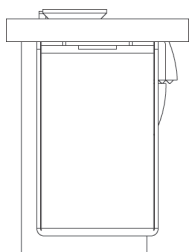

Full-size scale

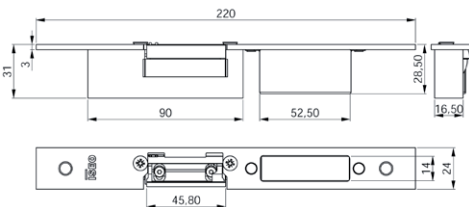

- ALL.CO All.Co 5 Porta / All.Co 5 TT Porta
- Export 50/50 TT Porta / Sicurblin 65
- ALU-K Alublindo / N 45 Porta / N 53 Porta / N 55 TT Porta
- N 62 TT Porta
- ALU-MEC Synthesis 57 Porta / Synthesis 60TT Porta
- DOMAL Stopper PG Porta
- ESA Blindal 60 Porta 1 Anta / 60 Porta 2 Ante
- INDINVEST Alpha 445 Porta 2 Ante
- METRA NC 45 International Porta
- NC 45 Superthermic Porta / NC 55 International Porta
- NC 68 Superthermic Porta / Nuovo NC 50 Porta Superblindo
- PASSERINI Ekip Blindo
- SCHUCO Royal 78 ST Blindato
- Royal S 50 N
- Royal S 55 TT
- Royal S 65 TT

ADJUSTABLE closed striking plate for **CENTRAL LOCK**

MULTIBLINDO EASY. Material: stainless steel.

With electric striker, unlatching during **12V A.C. 15W** electric pulse only.

Flat front-plate **24x3x220 DIN LEFT**

033210 D 10 - 10

Flat front-plate **24x3x220 DIN RIGHT**

033211 D 10 - 10

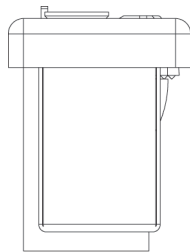

Full-size scale

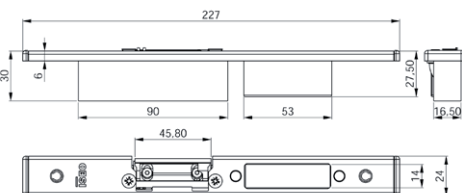

- ALCAN Abithal Keeper Porta 53-60 / 61-68
- Abithal Porta / Winner Porta
- ALCOA FB 12 Blindato Porta
- Plana 1 Anta / Plana 2 Anta
- ALL.CO All.Co 5 Porta / All.Co 5 TT Porta
- Export 50/50 TT Porta / Sicurblin 65
- ALNOR Montreal Porta
- ALUSUISSE Alesc 2000 Porta 59 / Alesc 2000 Porta 69
- ALU-K Alublindo / N 45 Porta / N 53 Porta / N 55 TT Porta
- N 62 TT Porta
- ALU-MEC Synthesis 57 Porta / Synthesis 60TT Porta
- BODEGA Extrablind 70
- DOMAL Domal Break 52 Porta / Domal Break 70 Porta
- Security Porta / Shops Porta / Stopper PG Porta
- ESA Blindal 60 Porta 1 Anta / 60 Porta 2 Ante
- Blindal 70 Porta 1 Anta / 70 Porta 2 Ante
- FRESIA Global 48 Porta
- INDINVEST Alpha 445 Porta 2 Ante
- METRA NC 45 International Porta
- NC 45 Superthermic Porta / NC 55 International Porta
- NC 68 Superthermic Porta / Nuovo NC 50 Porta Superblindo
- NEW TEC New Tec: 50 Porta Complanare
- OCMA SV 47 Porta 1 Anta
- SV 62 Porta 1 Anta
- SV 62 TT Porta 1 Anta
- PASSERINI Ekip Blindo
- Ekip Maastricht 53 Porta 1 Anta
- Ekip Maastricht 53 Porta 2 Ante
- Ekip Maastricht TH 60/68 Porta 1 Anta
- Ekip Maastricht TH 60/68 Porta 2 Ante
- Ekip Thermo 53 Porta
- PROFILATI PE " Eku 53" Porta
- PE "Eku 64 TT " Porta
- PE "Eku 72 Tt " Porta
- Sistema 1 PE 40 Complanare / Esterno 2 Ante
- Sistema 1 PE 40 Sormonto 2 Ante
- SCHUCO Royal 78 ST Blindato
- Royal S 50 N
- Royal S 55 TT
- Royal S 65 TT
- WICONA L60-A / L70-A

ADJUSTABLE closed striking plate for **CENTRAL LOCK**

MULTIBLINDO EASY. Material: stainless steel.

With electric striker, unlatching during **12V A.C. 15W** electric pulse only.

U-front plate **24x6x220 DIN LEFT**

033212 D 10 - 10

U-front plate **24x6x220 DIN RIGHT**

033213 D 10 - 10

For locks for metal frames series 7A*



Code

Status
Single package

Min. ord.

Multiblindo Easy



Full-size scale

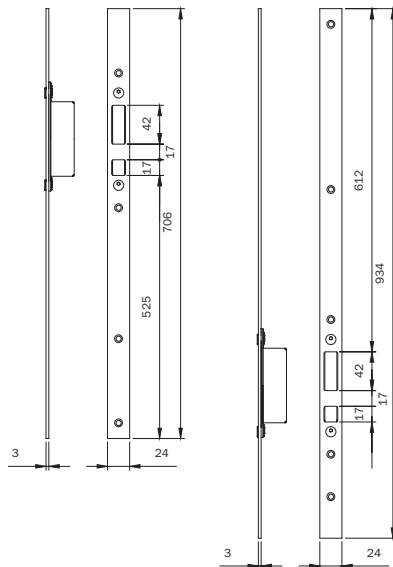

- ALL.CO All.Co 5 Porta / All.Co 5 TT Porta
- Export 50/50 TT Porta / Sicurblin 65
- ALU-K Alublindo / N 45 Porta / N 53 Porta / N 55 TT Porta
- N 62 TT Porta
- ALU-MEC Synthesis 57 Porta / Synthesis 60TT Porta
- DOMAL Stopper PG Porta
- ESA Blindal 60 Porta 1 Anta / 60 Porta 2 Ante
- INDINVEST Alpha 445 Porta 2 Ante
- METRA NC 45 International Porta
- NC 45 Superthermic Porta / NC 55 International Porta
- NC 68 Superthermic Porta / Nuovo NC 50 Porta
- Superblindo
- PASSERINI Ekip Blindo
- SCHUCO Royal 78 ST Blindato
- Royal S 50 N
- Royal S 55 TT
- Royal S 65 TT

Pair of **ADJUSTABLE** closed **STRIKING PLATES** for top/bottom **HOOK DEVIATORS** MULTIBLINDO EASY.

Material: stainless steel. Flat front plate **24X3X1860**

Can be used with central striking plates.

033200 - 033201 - 033210 - 033211 - 033160 - 033161

033165 B 10 - 10

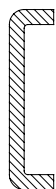

Full-size scale

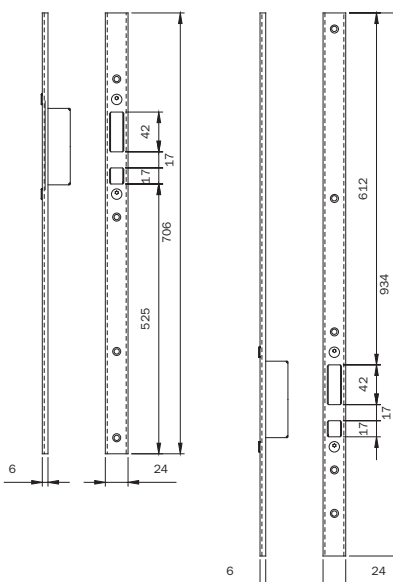

- ALCAN Abithal Keeper Porta 53-60 / 61-68
- Abithal Porta / Winner Porta
- ALCOA FB 12 Blindato Porta
- Plana 1 Anta / Plana 2 Ante
- ALL.CO All.Co 5 Porta / All.Co 5 TT Porta
- Export 50/50 TT Porta / Sicurblin 65
- ALNOR Montreal Porta
- ALUSUISSE Alesc 2000 Porta 59 / Alesc 2000 Porta 69
- ALU-K Alublindo / N 45 Porta / N 53 Porta / N 55 TT Porta
- N 62 TT Porta
- ALU-MEC Synthesis 57 Porta / Synthesis 60TT Porta
- BODEGA Extrablind 70
- DOMAL Domal Break 52 Porta / Domal Break 70 Porta
- Security Porta / Shops Porta / Stopper PG Porta
- ESA Blindal 60 Porta 1 Anta / 60 Porta 2 Ante
- Blindal 70 Porta 1 Anta / 70 Porta 2 Ante
- FRESIA Global 48 Porta
- INDINVEST Alpha 445 Porta 2 Ante
- METRA NC 45 International Porta
- NC 45 Superthermic Porta / NC 55 International Porta
- NC 68 Superthermic Porta / Nuovo NC 50 Porta
- Superblindo
- NEW TEC New Tec 50 Porta Complanare
- OCMA SV 47 Porta 1 Anta
- SV 62 Porta 1 Anta
- SV 62 TT Porta 1 Anta
- PASSERINI Ekip Blindo
- Ekip Maastricht 53 Porta 1 Anta
- Ekip Maastricht 53 Porta 2 Ante
- Ekip Maastricht TH 60/68 Porta 1 Anta
- Ekip Maastricht TH 60/68 Porta 2 Ante
- Ekip Thermo 53 Porta
- PROFILATI PE "Eku 53" Porta
- PE "Eku 64 TT " Porta
- PE "Eku 72 It " Porta
- Sistema 1 PE 40 Complanare / Esterno 2 Ante
- Sistema 1 PE 40 Sormonto 2 Ante
- SCHUCO Royal 78 ST Blindato
- Royal S 50 N
- Royal S 55 TT
- Royal S 65 TT
- WICONA L60A / L70A

Pair of **ADJUSTABLE** closed **STRIKING PLATES** for top/bottom **HOOK DEVIATORS** MULTIBLINDO EASY. Material: stainless steel.

U-front plate **24X6X1860**. Can be used with central striking plates

033202 - 033203 - 033212 - 033213 - 033162 - 033163

033167 C 10 - 10

For locks for metal frames
series 7A*



Code

Min. ord.
Multiple
package
Single
package
Status

Multiblindo Easy and Multiblindo Motion



Full-size scale

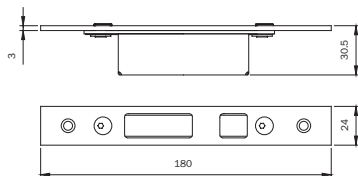

ALL.CO All.Co 5 Porta / All.Co 5 TT Porta
Export 50/50 TT Porta / Sicurblin 65
ALU-K Alublindo / N 45 Porta / N 53 Porta / N 55 TT Porta
N 62 TT Porta
ALU-MEC Synthesis 57 Porta / Synthesis 60TT Porta
DOMAL Stopper PG Porta
ESA Blindal 60 Porta 1 Anta / 60 Porta 2 Ante
INDINVEST Alpha 445 Porta 2 Ante
METRA NC 45 International Porta
NC 45 Superthermic Porta / NC 55 International Porta
NC 68 Superthermic Porta / Nuovo NC 50 Porta
Superblindo
PASSERINI Ekip Blindo
SCHÜCO Royal 78 ST Blindato
Royal S 50 N
Royal S 55 TT
Royal S 65 TT

ADJUSTABLE closed striking plate for **HOOK DEVIATORS**

MULTIBLINDO EASY and MULTIBLINDO EMOTION.

Material: stainless steel. Flat front plate **24X3X180**.

To be used with striking plates.

033200 - 033201 - 033210 - 033211 - 033160 - 033161

033169 A 10 - 10

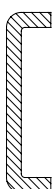

Full-size scale

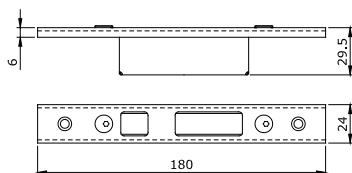

ALCAN Abithal Keeper Porta 53-60 / 61-68
Abithal Porta / Winner Porta
ALCOA FB 12 Blindato Porta
Plana 1 Anta / Plana 2 Ante
ALL.CO All.Co 5 Porta / All.Co 5 TT Porta
Export 50/50 TT Porta / Sicurblin 65
ALNOR Montreal Porta
ALUSUISSE Alsec 2000 Porta 59 / Alsec 2000 Porta 69
ALU-K Alublindo / N 45 Porta / N 53 Porta / N 55 TT Porta
N 62 TT Porta
ALU-MEC Synthesis 57 Porta / Synthesis 60TT Porta
BODEGA Extrablindo 70
DOMAL Domal Break 52 Porta / Domal Break 70 Porta
Security Porta / Shops Porta / Stopper PG Porta
ESA Blindal 60 Porta 1 Anta / 60 Porta 2 Ante
Blindal 70 Porta 1 Anta / 70 Porta 2 Ante
FRESIA Global 48 Porta
INDINVEST Alpha 445 Porta 2 Ante
METRA NC 45 International Porta
NC 45 Superthermic Porta / NC 55 International Porta
NC 68 Superthermic Porta / Nuovo NC 50 Porta
Superblindo
NEW TEC New Tec 50 Porta Complanare
OCMA SV 47 Porta 1 Anta
SV 62 Porta 1 Anta
SV 62 TT Porta 1 Anta
PASSERINI Ekip Blindo
Ekip Maastricht 53 Porta 1 Anta
Ekip Maastricht 53 Porta 2 Ante
Ekip Maastricht TH 60/68 Porta 1 Anta
Ekip Maastricht TH 60/68 Porta 2 Ante
Ekip Thermo 53 Porta
PROFILATI PE "Eku 53" Porta
PE "Eku 64 TT " Porta
PE "Eku 72 Tt " Porta
Sistema 1 PE 40 Complanare / Esterno 2 Ante
Sistema 1 PE 40 Sormonto 2 Ante
SCHÜCO Royal 78 ST Blindato
Royal S 50 N
Royal S 55 TT
Royal S 65 TT
WICONA L60-A / L70-A

ADJUSTABLE closed striking plate for **HOOK DEVIATORS**

MULTIBLINDO EASY and MULTIBLINDO EMOTION.

Material: stainless steel.

U-front plate **24X6X180**. To be used with striking plates.

033202 - 033203 - 033212 - 033213 - 033162 - 033163

033171 A 10 - 10